

New Chemical Research Institute with cutting-edge equipment began operations.

Kumiai Chemical Industry Co. Ltd. (Head Office: Taito-ku Tokyo; President: TAKAGI Makoto) announces that the Chemical Research Institute “Shimizu Innovation Park(ShIP),” began operations to realize a safe, secure, and prosperous society by creating new innovative technologies in agrochemical and chemical fields on Monday, October 2, 2023.

Our new Chemical Research Institute (ShIP) is the latest and most advanced institute that has integrated three chemical research centers previously scattered throughout Shizuoka Prefecture in the Shimizu-ku, Shizuoka-shi, where Kumiai was founded. This Chemical Research Institute (ShIP) was built based on the concept of (1)Environment for imagination and free ideas, (2)Environment for continuous technical improvement and challenge, (3)Sharing innovations, (4)Safe, secure and comfortable work environment, (5)Improvement of our brand image. The nickname “ShIP” is based on the image of a voyage from Shimizu seaport to the open sea, and on the expectation of synergy and the creation of new innovations by bringing researchers together in different fields and strengthening their collaboration.



■ Work space to promote interaction

To realize the above concepts, workspaces connected by a stairwell and a grand staircase, open meeting rooms, and a cafeteria are arranged to promote interaction among researchers in different research fields. We expect the involvement and interaction among researchers and employees worked at three different research centers across disciplines will create new innovations.

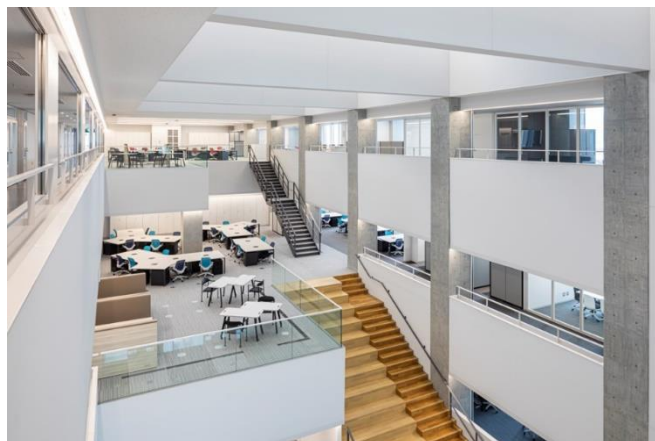

■ A sustainable institute that achieves both improvement of experimental efficiency and environmental responsiveness.

We introduced the latest and most advanced experimental equipment and energy saving facilities to ShIP, to improve both experimental efficiency and environmental friendliness. We have networked experimental equipment in a whole building wireless LAN environment, adopted electronic lab notebooks, and introduced a reagent management system, etc. In addition to compliance with laws and regulations, the laboratories are sustainable and environmentally friendly facilities with local exhaust ventilation facilities that give the utmost consideration to the working environment of the researchers, a state-of-the-art scrubber and activated sludge tank for the treatment of exhaust and waste water generated in experiments, and solar panels to supply part of the electricity in the building.



Kumiai Chemical is committed to research and development of new agrochemicals and fine chemicals that are sustainable and ESG-conscious in order to contribute to the realization of a more stable supply of agricultural products and a prosperous society under the theme of protecting and fostering life and nature through creative science. Through our integrated research and development systems by New Chemical Research Institute and Life Science Research Institute, from exploratory synthesis, biological evaluation, formulation, establishment of industrial manufacturing process for new compounds, we will promote the development of unique products added value and suited market needs.

■ Overview of new Chemical Research Institute

Address	100, Shibukawa, Shimizu-ku, Shizuoka-shi, Japan
Building structure	Reinforced concrete structure, 5 floors above ground
Total floor area	8,671 m ²
Site area	19,935 m ²

<Inquiry for this press release>
Kumiai Chemical Industry Co., Ltd.

Customer Inquiry Form (<https://www.kumiai-chem.co.jp/english/contact.html>)